

# How To Use Upper Clamp Holes On The Super FMT



Long and/or heavy mortise boards may require outboard support

## Leigh Super FMT Clamping

The following seven steps detail the procedure for using both clamps in the upper clamp holes on one side of the Super FMT clamp plate. Before inserting the clamps, tilt the clamp plate up fully and tighten the clamp plate knobs.

**Note:** The clamp plate has been removed from the jig body for clarity.

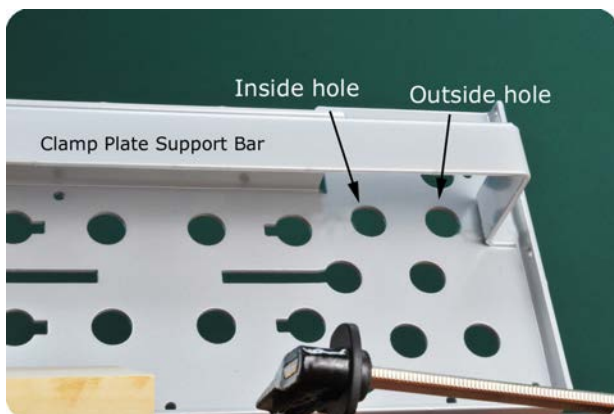

**1** Clamps must be inserted in the correct order. Always start with the outside clamp plate hole.



**2** Insert the first clamp from **UNDER** the clamp plate support bar and into the outside clamp hole. **Note:** The tip of the clamp must point towards the center of the jig. ①

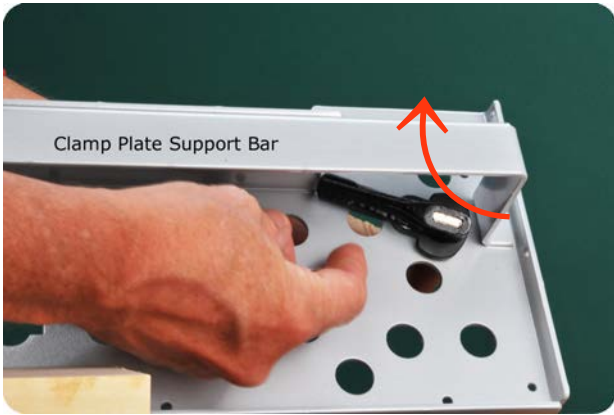

**3** Push the clamp arm through the outer clamp hole and rotate upwards **BEFORE** seating the clamp.

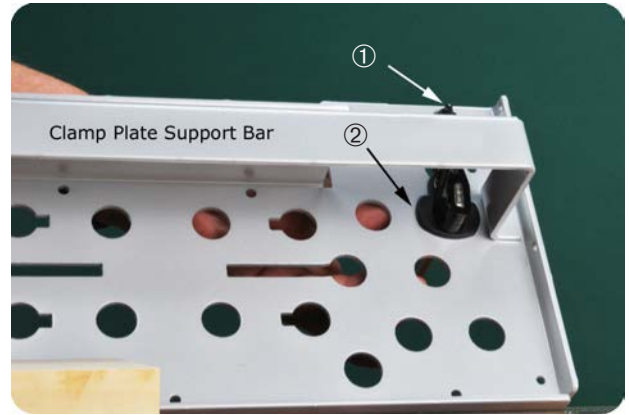

**4** Continue rotating the clamp to the vertical position ① then seat in the clamp hole. ②

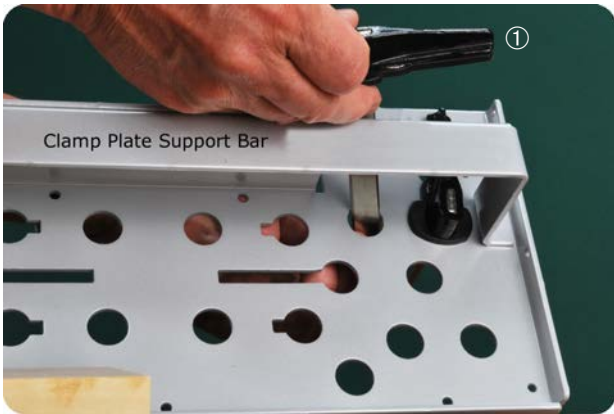

**5** Insert the second clamp in the inner clamp hole from **ABOVE** the clamp plate support bar. Note: The tip of the clamp points to the outside ① of the clamp plate as it is inserted in the clamp hole.

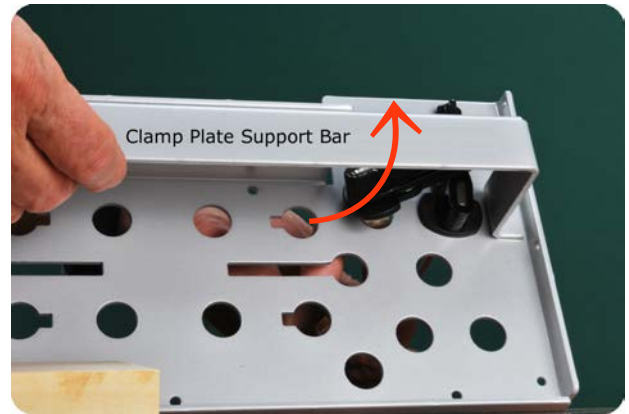

**6** Push the clamp arm through the clamp hole and rotate upwards **BEFORE** seating in the clamp hole.

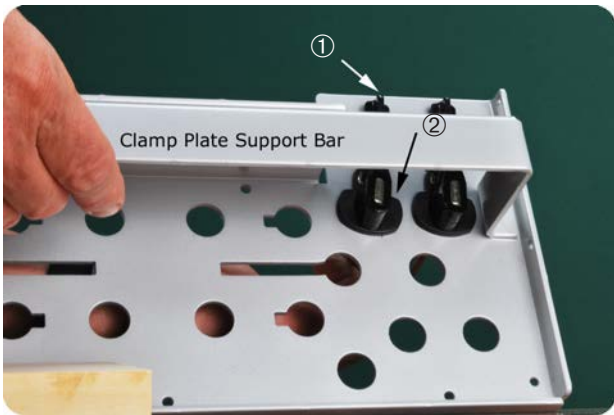

**7** After rotating the clamp to the vertical position ① seat the clamp in the clamp hole ②. **To Remove, repeat steps 2 through 7.**