

Guidebush Selection

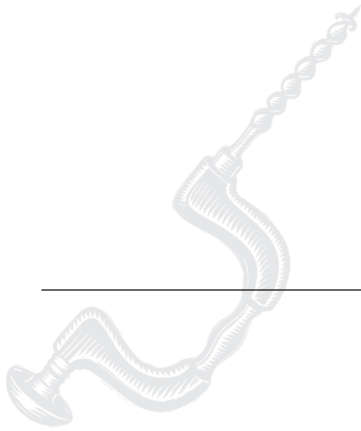

Foreword

The correct guidebush is the vital link between the router and your Leigh Jig. It precisely steers the router. Where possible, always use the Leigh system **to ensure correct bush length and precise diameter for accurate results.**

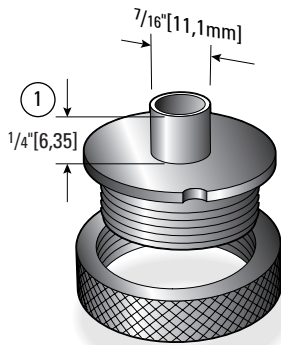

711 TP

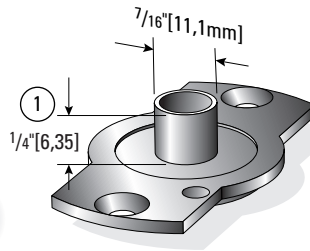

711

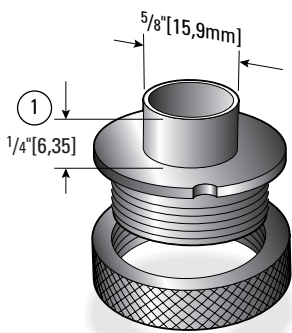

716 TP

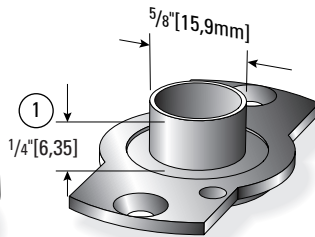

716

Guidebush Selection

Only two sizes of guidebush are used with the Leigh jig*: 7/16" [11,1mm] O.D. (outside diameter) and 5/8" [15,9mm] O.D.

Bush barrel length ① from base of router should be 1/4 - 3/32" [6 - 7mm].

Use 7/16" [11,1mm] for all half-blind dovetailing and for through dovetailing with 1/4" [6,35mm] or 8mm shank cutters: i.e., dovetail cutter Nos. 50, 50-8, 60, 60-8, 70, 70-8, 75, 75-8, 80, 80-8, 101, 101-8, 120, 120-8, 128, 128-8, and straight cutter Nos. 140 and 140-8.

Use 5/8" [15,9mm] O.D. for large through dovetail cutter combinations with 1/2" [12,7mm] shanks: i.e., cutter Nos. 90, 160, 100, 150.

Here are the two types of Leigh guidebush and five Leigh adapters. Use the chart on page 153 to select the adaptor and/or guidebush required for your router.

**Except for sliding dovetails (see page 113).*

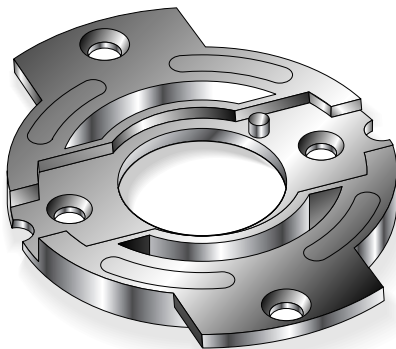

Adapter No. 702

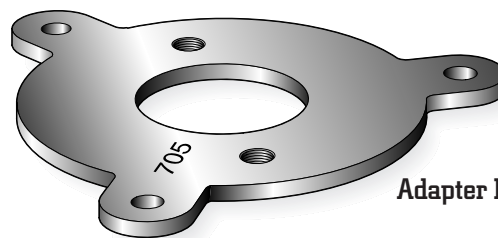

Adapter No. 705

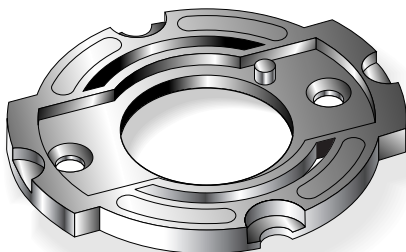

Adapter No. 703



Adapter No. 706

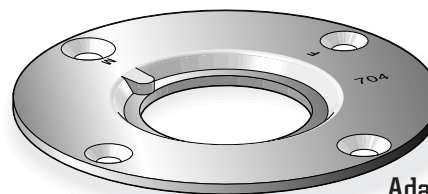

Adapter No. 704

Appendix I D4 User Guide

Leigh 711 and 716 guidebushes fit directly to some routers using the screws that come with the router.

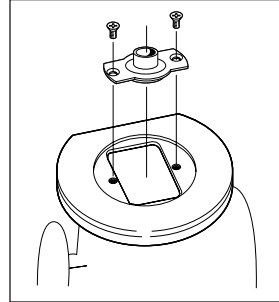

Leigh 711TP and 716TP (TP stands for Two Part) fit directly to Porter Cable and most Black & Decker routers.

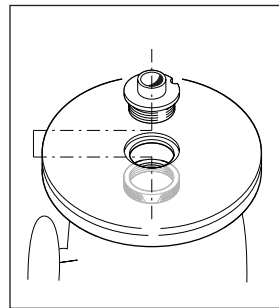

Leigh universal adapters fit to a wide range of plunge routers and accept both types of Leigh bush.

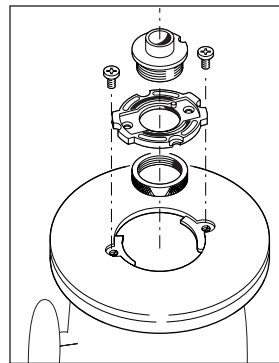
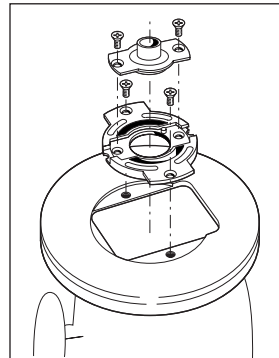

Check the make and model of your router in the left hand column. Where possible always order the Leigh adaptors and guidebushes (in red) which are specially designed for use on Leigh jigs. Other adaptors or guidebushes must be purchased from the manufacturer's own distributor.

Note: Ideal barrel depth is 1/4" to 9/32" (6mm to 7mm) below the router base. Other manufacturers' guidebushes may require careful cutting to length.
 ◆ Guidebush mounting screws are provided with adaptor and adaptor mounting screws are provided with router.
 ▼ 5/8" (15.9mm) O.D. guidebushes are used only with 1/2" (12.7mm) shank router bits. ■ MAPELL – Rework the adaptor slightly. ● SCHEER – Rework the router base slightly.

ROUTER MAKER	ROUTER MODEL	LEIGH OR ROUTER MAKER'S ADAPTOR NO.	7/16" (11.1mm) OUTSIDE DIA. GUIDE BUSH NO.	5/8" (15.9mm) OUTSIDE DIA. GUIDE BUSH NO. ▼	METHOD OF ATTACHMENT
AEG	OFE 710 in plunge base	No adaptor required	711	716	Screws incl. w/router
	OFSE 2000	703	711	716	◆
ATLAS COPCO	OFE 710 in plunge base, OFE 1000	No adaptor required	711	716	Screws incl. w/router
	OFSE 2000	703	711	716	◆
AXMINSTER WHITE	AW635R	No adaptor required	711	716	Screws incl. w/router
	AW127R	Adaptor supplied w/router	711	716	Screws incl. w/router
BLACK & DECKER	All Professional, HD 1250, RP400K	No adaptor required	711TP	716TP	Threaded nut included
	6200	720673-00	711TP	716TP	2 screws req'd. 249412-20
	SR100, 7AEE, KW780 series	No adaptor required	711	716	Screws incl. w/router
BOSCH	90140, 90098, 90088	No adaptor required	82855	82854	Screws included
	90085, 90150, 90300, 90303, 90305, 91284		82859	82864	Screws included
	1600, 1601, 1602, 1603, 1604, 1606, B1350	2 610 906 290	711TP	716TP	Threaded nut included
	1613, 1613EVS, 1613AEVS, 1614, 1614EVS, 1617, 1617EVS, 1618EVS, 1619EVS, B1450, POF800ACE, GOF900ACE, GOF1300ACE, GOF2000CE	No adaptor required (RA1100 required for VGS)	RA1107	RA1113	No screws required
	1611, 1611 EVS, 1615, 1615 EVS, B1550	702	711	716	◆
	GOF1600, GOF1700ACE				
CASALS	FT750, FT 1000E, FT2000E	703	711	716	◆
CMT	1E	702R	711	716	◆
CRAFTSMAN (SEARS)	All non-plunge models	No adaptor required	Set of 3 bushes from Sears USA order no.25082 (stamped steel) or 25090 (plastic). Set of 3 bushes from Sears Canada order no.092-970-704		Screws incl. w/set
	135275070 Plunge				
	Other plunge models	702	711	716	◆
DEWALT	DW610	No adaptor required	711TP	716TP	Threaded nut included
	DW613	No adaptor required	711	716	Screws incl. w/router
	DW614, DW615, DW621	North America Only	711TP	716TP	Threaded nut included
	DW624, DW625 and DW626	Adaptor supplied w/router			
	DW621K and DW626 outside N. America	706	711	716	◆
	DW625 Type 1, 2 & 3 outside N. America	702	711	716	◆
EINHELL	DW625 Type 4 outside N. America, DW625EK	702R	711	716	◆
	EOF 850 SP, OF-G 1100E	No adaptor required	711	716	Screws incl. w/router
ELU	OF15, OF15E, OF97, OF97E	706	711	716	◆
	MOF68, MOF69, MOF96, MOF96E	No adaptor required	711	716	Screws incl. w/router
	MOF131, MOF177 Type 1, 2 & 3	702	711	716	◆
	MOF177 Type 4, MOF177EK	702R	711	716	◆
	2720, 2721, 3328	No adaptor required	711TP	716TP	Threaded nut included
	3303, 3304	E09600 or 761 270-00	711TP	716TP	Threaded nut included
FEIN	3337, 3338, 3339	702	711	716	◆
	RT1800	Adaptor supplied w/router	711TP	716TP	◆
FESTOOL	OF1E, OF2E, OF650, OF800E, OF1000, OF1010E	704	711TP	716TP	Threaded nut included
	OF2000, OF2000E	705	711	716	◆
FLEX	All	No adaptor required	711TP	716TP	Threaded nut included
FREUD	FT2000	703	711	716	◆
HITACHI	TR8, TR12, FM8, M8, M12 Series	703	711	716	◆
HOLZ-HER	2355, 2356	No adaptor required			Screws incl. w/router
	2365	702	711	716	◆
ISKRA	MR808A Series	No adaptor required	711	716	Screws incl. w/router
JEPSON	7412	703	711	716	◆
KANGO	OF808	No adaptor required	711	716	Screws incl. w/router
KRESS	OF690 IE Series	No adaptor required	711	716	Screws incl. w/router
MAPELL	LOG5E	702 ■	711	716	◆
MAKITA	3600, 3606, 3608, 3612, 3612B, 3612BR	703	711	716	◆
	3612C N. America, 3620, 3621				
	3612C Europe Qk. Fit Base	Contact your National Leigh distributor			
	3601B	321 493-1	711TP	716TP	Threaded nut included
METABO	RP0910, RP1110C	706	711	716	◆
	RF1100, RF1101, RD1100, RD1101, RP1101	No adaptor required	711TP	716TP	Threaded nut included
	OF1612, OFE1812	704	711TP	716TP	Threaded nut included
MILWAUKEE	All	No adaptor required	49-54-0520	49-54-0550	Screws included
PERLES	OF808 Series, OFE 6990	No adaptor required	711	716	Screws incl. w/router
PORTER CABLE(Rockwell)	All	No adaptor required	711TP	716TP	Threaded nut included
POWER DEVIL	All	No adaptor required	711	716	Screws incl. w/router
RYOBI	R30, R50, R150, R151, RE155, R161	703	711	716	◆
	R500, R501, R502				
	R600, R601, RE600, RE601	702	711	716	◆
	R160, R165, R170, R175, RE175, R180, R185	706	711	716	◆
SCHEER	HM9, HM14, HM14-12, HM18, HM18-E	No adaptor required ●	711	716	Screws incl. w/router
SKIL	1823 or 1835	91803	711TP	716TP	Threaded nut included
	All others	No adaptor required	11592	71021	Nut 11587
STANLEY	All		See Bosch Distributor		
STAYER	PR50 Series	No adaptor required	711	716	Screws incl. w/router
TREND (FELLISATI)	T5	No adaptor required	711	716	Screws incl. w/router
	T9	Adaptor supplied w/router			
WEGOMA	OF850 Series	No adaptor required	711	716	Screws incl. w/router

