

LEIGH  USER GUIDE

Finger Joint Template



Your New Leigh Fingerjoint Template

You now own a unique finger jointing system. The Leigh F1 template and Variable Guidebush System (VGS) will help you rout a variety of square and rounded finger or box joints with unique adjustment for precise tightness of fit. “Finger” and “Box”: Both words are used universally to title this simple but strong joint. As the first machine-made joint, it’s old enough to be called antique, so we have been even-handed in using both terms throughout this guide. We recommend that you first mount the F1 on your D Series Leigh Jig carefully following the instructions in the first section of the manual.

Then read the rest of the manual, following along with the basic functions, before you try to do any actual joinery routing. By all means, cut a few practice joints in scrap boards before you use the F1 to rout a precious hardwood workpiece.

If you have any questions that are not answered in the manual, please call the most convenient Leigh customer support line *.

*See Appendix IV – Customer Support

Important: Inches and Millimetres

Leigh makes the F1 attachment in two models; inch or metric. Text and illustrations in this Leigh English-language user guide indicate dimensions in both inches and millimetres. Dimensions are indicated in text and illustrations with “inches” first, followed by “millimetres” in square parentheses.

Example:

$\frac{3}{4}$ " x $5\frac{1}{2}$ " x 8" or longer [20 x 140 x 200mm]

Do not be concerned if the inch/millimetre equivalents are not always exact. Just use the dimensions which apply to your jig.

Where finger assembly or template scales overlay an illustration, the “inches” scale ① will be at the top, the “millimetres” scale ② will be at the bottom. Only the right “active” half of the scales are illustrated. For clarity, setting positions are indicated in the manual with a red line. **On the jig, the lines are black.**

General views of the template will show inch markings ③.

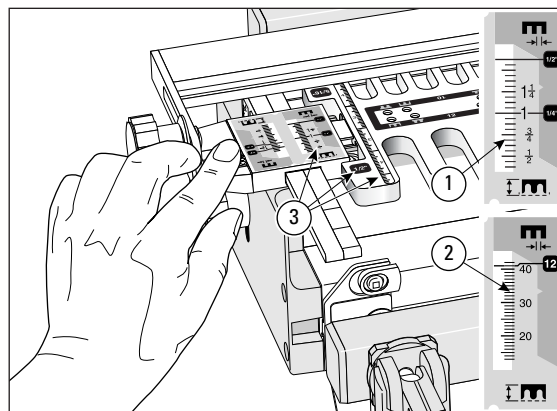

Glossary of Symbols.....	iv
CHAPTER 1 - Assembly, Mounting and Template Alignment.....	1
CHAPTER 2 - Using Your Template Safely.....	15
CHAPTER 3 - Operation Concepts and Basic Template Functions.....	21
CHAPTER 4 - The Variable Guidebush System (VGS).....	27
CHAPTER 5 - Board Width Selection.....	33
CHAPTER 6 - Box Joint Procedures	39
CHAPTER 7 - Rounded Half-Blind Finger Joint Procedures.....	49
CHAPTER 8 - Square Half-Blind Box Joint Procedures.....	57
CHAPTER 9 - Rabbetted Half-Blind Finger Joints.....	63
CHAPTER 10 - Small Box Joints	67
CHAPTER 11 - Wider Box Joints	79
CHAPTER 12 - Hints and Tips.....	85
Appendix I - Variable Guidebush Selection.....	91
Appendix II - Cutter Selection and Joint Specification.....	97
Appendix III - Template Parts List	101
Appendix IV - Customer Support.....	105

How to Read the Symbols

To help you understand the instructions and illustrations in this manual, we have used a number of international symbols, plus a few special ones of our own. They are all explained below. You needn't worry about memorizing these symbols now, because they are repeated quite frequently in the manual, and you will soon get used to them.

Glossary of Symbols

The Leigh F1 template can be in one of only two modes with either the $\frac{1}{2}$ " and $\frac{1}{4}$ " [12mm] comb sizes to the front or the $\frac{3}{8}$ " and $\frac{5}{16}$ " [10 and 8mm] comb sizes to the front.

Scale Icons



This icon on the green scale background indicates the active scale for square box joints.



This icon on the gray scale background indicates the active scale for rounded finger joints.

Template Icons



Indicates the two template positions for square box joints



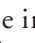

Indicates the two template positions for rounded finger joints

Which Way Round Should the Board Go?

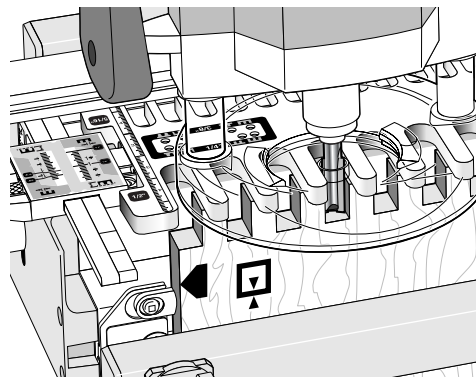
Most joinery done on the Leigh jig is for case-work (i.e., boxes, cabinets, drawers, chests and so on) so in nearly all the illustrations we have indicated **which side of the board shows outwards when it is in the jig**, eg. in this figure the inside face  of the tail board is away from the jig.



 This indicates the side of the board that will face outward on the finished project.

 This indicates the side of the board that will face inward on the finished project.

 This indicates a side that can face either inward or outward on the finished project

 Dotted line icons are on the other side of the board.

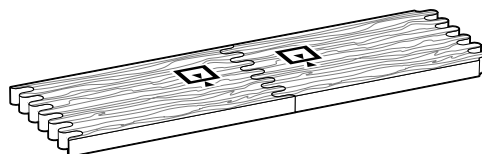
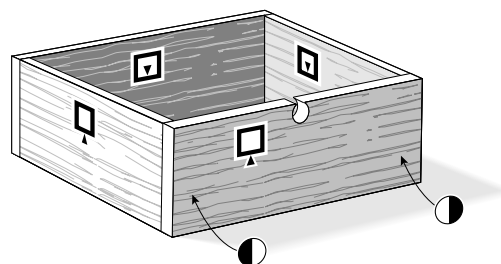

The following symbols indicate:

 Left side of item (drawer, box, case, etc.)

 Right side of item

 Top of item

 Bottom of item

 This edge against side stop

 This edge against side stop

 As above, other side of board

 Sawcut allowance

 Caution: use special care for this operation

①②③ Reference in text

 Diameter

 Centreline of board or layout

 Equals

 Does not equal

 Approximately

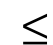
 Less than or equal to

 Greater than or equal to

